



PHARMALOK™ Clamps

The biopharmaceutical industry has made a strong move towards single-use technology, so Nordson MEDICAL has developed ground-breaking clamp designs that simplify the assembly process. Effortlessly and securely attach sanitary fittings to bag ports and filters with PharmaLok™ Easy-Open Clamps, and close off flow with PharmaLok™ Tube Clamps.

SINGLE-USE & EASY-OPEN CLAMPS

- ASME BPE 018 DT-7-1 compliant & DIN compliant
- Easy to use, one-handed closure - no tools needed
- Repeatable use with constantly equal pressure on the gasket
- Tamper evident & zip tie compatible
- 360° compression
- Connects both plastic and stainless steel fittings
- SIP/CIP compatible

SPECIFICATIONS

- **Materials:**
Zytel® FGFE5171 glass-filled nylon certified to USP Class VI & ISO 10993 and available in white, blue, or orange
- **Temperature & Sterilization:**
Normal operating temperature -94° F (-70° C) to 140° F (60° C)
Cryogenic freezing to -112° F (-80° C)
Autoclavable up to 273° F (134° C) for a maximum of 30 min.
Gamma radiation up to 50 kGy
X-ray sterilization up to 50 kGy
- **Maximum Pressure:**
80 psi (conforms to ASME BPE-2022)
- **Sterilization:**
Fitting .5" (12.7 mm) to .75" (19.0 mm), 1" (25.4 mm) to 1.5" (31.8 mm), 3" (76.2 mm), and 4" (101.6 mm)

TUBE CLAMPS FEATURES & BENEFITS

- Designed for use with silicone & TPE tubing
- Easy to use, one-handed closure - no tools needed
- Tamper evident & zip tie compatible

SPECIFICATIONS

- **Materials:**
Zytel® FGFE5171 glass-filled nylon certified to USP Class VI & ISO 10993 and available in white or orange
- **Temperature & Sterilization:**
Normal operating temperature -94° F (-70° C) to 140° F (60° C)
Cryogenic freezing to -112° F (-80° C)
Autoclavable up to 273° F (134° C) for a maximum of 30 min.
Gamma radiation up to 50 kGy
X-ray sterilization up to 50 kGy
- **Maximum Pressure:**
Up to 150 psi
- **Sizes:**
Thin-Walled Tube Clamp Size, Standard Tube Clamp Size, and Large Tube Clamp Size (full details continued on rear)

PHARMALOK™ Clamps



Easy-Open Clamps

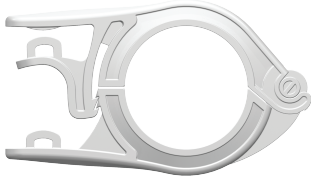

CPAX150 (-U71, -U75, -U706)
Tri-Clover Easy-Open Clamp for Maxi Flange, 1" (25.4 mm) to 1.5" (38.1 mm), Glass-Reinforced White, Blue, or Orange Nylon

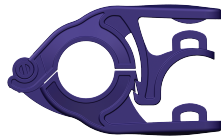

CPAN75 (-U71, -U75, -U706)
Tri-Clover Easy-Open Clamp for Mini Flange, .5" (12.7 mm) to .75" (19.0 mm), Glass-Reinforced White, Blue, or Orange Nylon

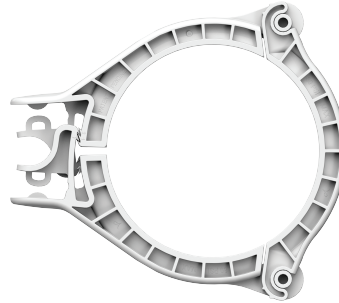

CPAX400 (-U71)
Tri-Clover Easy-Open Clamp for 4" (101.6 mm) Flange, Glass-Reinforced White Nylon

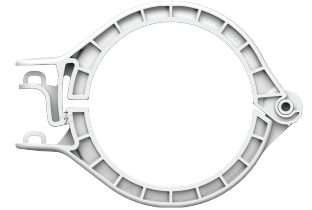

CPAX300 (-U71)
Tri-Clover Easy-Open Clamp for 3" (76.2 mm) Flange, Glass-Reinforced White Nylon

Single-Use Clamps

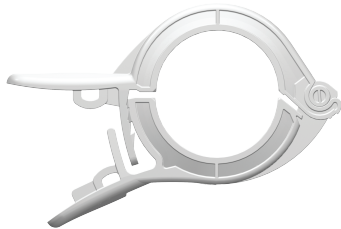

CPX150 (-U71)
Single-Use Series Clamp, TC Version 1" (25.4 mm) to 1.5" (38.1 mm), Glass-Reinforced White Nylon



CPN75 (-U71)
Single-Use Series Clamp, TC Version .5" (12.7 mm) to .75" (19.0 mm), Glass-Reinforced White Nylon

Tube Clamps



CPT90 (-U71, -U706)
PharmaLok™ Small and Thin-Walled Tube Clamp
Minimum tubing ID of 1/16" (1.59 mm) with 1/32" (0.79 mm) wall thickness
Maximum tubing OD of 1 1/8" (28.58 mm) with 3/32" (2.38 mm) wall thickness
Glass-Filled White or Orange Nylon



CPT100 (-U71, -U706)
PharmaLok™ Standard Tube Clamp
Minimum tubing ID of 1/2" (12.7 mm) with 3/32" (2.38 mm) wall thickness
Maximum tubing OD of 1 1/4" (31.75 mm) with 3/16" (4.76 mm) wall thickness
Glass-Filled White or Orange Nylon



CPT110 (-U71, -U706)
PharmaLok™ Large Tube Clamp
Minimum tubing ID of 3/4" (19.05 mm) with 1/8" (3.18 mm) wall thickness
Maximum tubing OD of 2" (50.8 mm) with 1/4" (6.35 mm) wall thickness
Glass-Filled White or Orange Nylon